

# ICEWORKS



## A Great Place for Hockey



# IceWorks Skating Complex

- State-of-the-art four rink facility
- Two full service restaurants, each seating 220, with view of both ice surfaces
- Spacious, clean locker rooms
- Fully stocked Pro Shop with friendly service, expert skate sharpening and on-site embroidery
- Arcade games
- [www.iceworks.net](http://www.iceworks.net)



# ICEWORKS

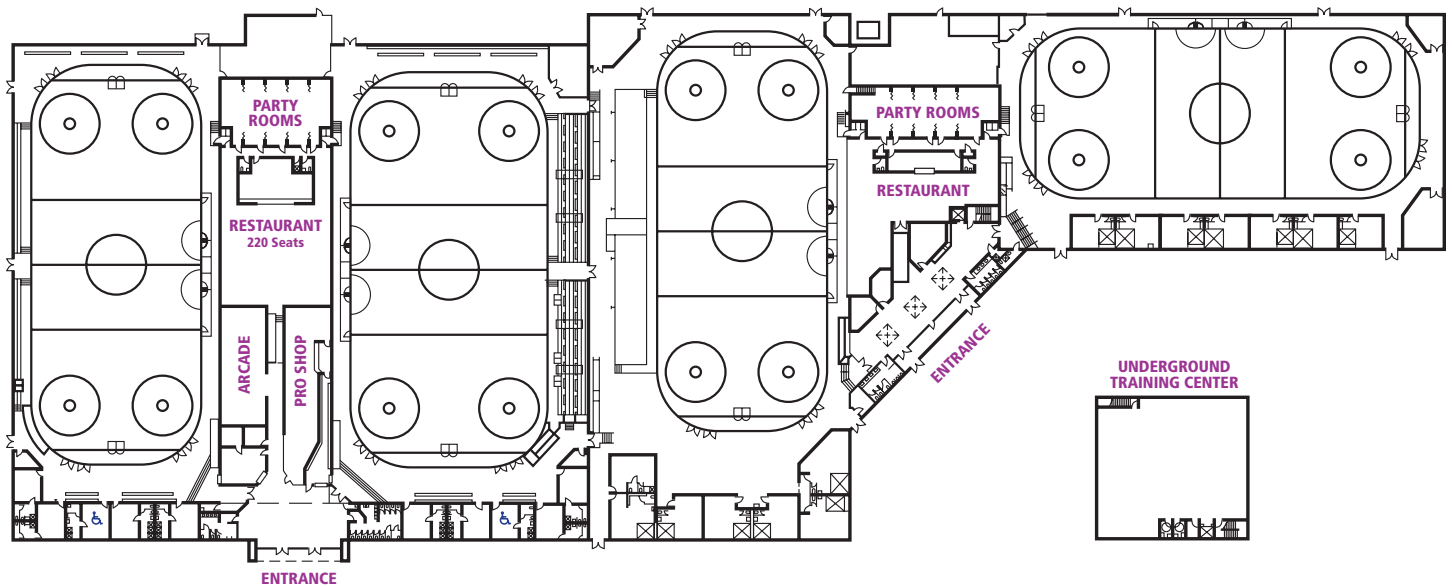

IceWorks Twin Rinks of Aston opened its doors to the public in October of 1997. The building consisted of two ice surfaces, a full-service restaurant, full-service pro shop, arcade, and banquet/party rooms.

Since opening, IceWorks has been busy with games from local school teams, in-house teams, the Delco Phantoms and the Philadelphia Little Flyers.

IceWorks is the only public rink in the United States or Canada that has a professional coaching staff. Jim Watson, a former Philadelphia Flyer, leads the Hockey staff along with the rink's General Manager Stephane Charbonneau. Uschi Keszler, coach of Olympic skater Elvis Stojko, leads a Figure Skating staff of 18 full-time coaches.

In the fall of 2001, the IceWorks Skating Complex opened two more ice rinks to accommodate more hockey teams and figure skaters. IceWorks is proud to serve the community with a fun, clean facility where they will be greeted by a smiling and knowledgeable staff.



JIM WATSON



STEPHANE CHARBONNEAU



# IceWorks Restaurants

- Two full service restaurants offering daily breakfast, lunch and dinner selections.
- Extended menu and daily specials prepared by Chef Lou Tiernan
- Glass enclosed—offering you a full view of the activity in all rinks
- Offers catering services for team parties
- Offers private dining and party rooms



# Things To Do in Philadelphia

When you're at IceWorks for a tournament, you're just a slapshot away from a glorious day in Philadelphia. Sightseeing, shopping, dining—it's all there for you.

## INDEPENDENCE NATIONAL & HISTORIC PARK

Independence National Historical Park, located in downtown (called "Center City"), Philadelphia, is often referred to as the birthplace of our nation. At the park, visitors can see the Liberty Bell, an international symbol of freedom, Independence Hall, a World Heritage Site where both the Declaration of Independence and the U.S. Constitution were created. You won't want to miss the beautiful new National Constitution Center. This interactive museum is the first dedicated to honor and perpetuate the ideas embodied in the U.S. Constitution. With more than 100 multimedia exhibits, you can watch an oath ceremony video, cast your vote for your favorite president of all time and sign the Constitution.



## HISTORIC PHILADELPHIA

Philadelphia's historic district is alive with activity all-year round! With dozens of wonderful attractions, from the Liberty Bell to other hidden treasures, your trip to Philadelphia will be most memorable! As you stop by Philadelphia's famous, and not-so-famous, sites, you'll hear the sounds of the colonial Fife and Drum Corps. You'll even encounter some real-life colonial Philadelphians!



## GREAT RESTAURANTS

Sit. Eat. We have some spectacular 5-star restaurants, and dozens more that are merely terrific.

Every price range, too: South Philly Italian, Chinatown's best, French Country inns, and of course Manayunk, that hillside town within our town that's a shrine to calories and art. And foodies from all over the world love the fragrant bustle of Reading Terminal Market, a farmer's market that could be in Paris but fortunately, isn't.

## FRANKLIN INSTITUTE

Interested in science... and fun? The Franklin Institute offers IMAX films, enjoyable shows, and informative exhibits.

## PHILADELPHIA MUSEUM OF ART

The Philadelphia Museum of Art is among the largest and most important art museums in the United States. The American collections include extensive holdings of Pennsylvania German art; refined furniture and silver by early Philadelphia craftsmen; and the most important collection in the world of works by Philadelphia artist Thomas Eakins.

And yo, you can even run up the steps like Rocky!



# Area Attractions and Lodging



## HOTELS

- |   |  |  |  |
|---|--|--|--|
| <p><b>1 Best Western<br/>Concordville Hotel</b><br/>Routes 1 &amp; 322<br/>Concordville, PA 19301<br/>610-358-9400</p>                                  | <p><b>5 Doubletree Hotel –<br/>Wilmington</b><br/>4727 Concord Rd<br/>Wilmington, DE 19803<br/>302-478-1700</p>  | <p><b>9 Holiday Inn Select</b><br/>630 Naamans Road<br/>Claymont, DE 19703<br/>302-791-4680</p>  | <p><b>13 Renaissance<br/>Philadelphia Hotel</b><br/>500 Stevens Drive<br/>Philadelphia, PA 19113<br/>610-521-5900 or 1-800-hotels-1<br/>Contact: Jason Richardson x 6112</p> |
| <p><b>2 Comfort Inn &amp; Suites –<br/>Brandywine</b><br/>1310 Wilmington Pike, Rt 202<br/>West Chester, PA 19382<br/>610-399-4600, Contact: Sharon</p> | <p><b>6 Hampton Inn –<br/>Philadelphia Airport</b><br/>8600 Bartram Ave<br/>Philadelphia, PA 19153<br/>Janice Jones: 215-966-1300<br/><i>Complimentary Hot Breakfast</i></p> | <p><b>10 Holiday Inn Select –<br/>Swedesboro</b><br/>1 Pureland Drive, Swedesboro, NJ<br/>856-467-3322 ext 510<br/>Contact: Robin<br/><i>Continental Breakfast</i></p> |  |
| <p><b>3 Courtyard by Marriott –<br/>Philadelphia Airport</b><br/>8900 Bartram Avenue<br/>Philadelphia, PA 19153<br/>215-365-2200</p>                    | <p><b>7 Holiday Inn – Brandywine</b><br/>4000 Concord Pike<br/>Wilmington, DE 19803<br/>302-478-2222</p>   | <p><b>11 Ramada Inn –<br/>Philadelphia Airport</b><br/>76 Industrial Hwy<br/>Essington, PA 19029<br/>610-521-9600, Contact: Kathy</p>                                  |  |
| <p><b>4 Courtyard by Marriott –<br/>Wilmington</b><br/>1102 West Street<br/>Wilmington, DE 19801<br/>Kelly West: 302-429-7600</p>                       | <p><b>8 Holiday Inn Express</b><br/>Route 1 and Route 202<br/>Chadds Ford, PA<br/>610-358-1700</p>   | <p><b>12 Red Roof Inn<br/>Philadelphia Airport</b><br/>49 Industrial Hwy<br/>Essington, PA 19029<br/>610-521-5090</p>  |  |

## ATTRACTIONS

- 1 Brandywine Battlefield Park
- 2 Fort Mifflin on the Delaware
- 3 Chaddsford Winery
- 4 QVC Studio Tour
- 6 West Chester Railroad
- 7 American Helicopter Museum & Education Center
- 8 The Franklin Mint Museum & Library
- 9 Winterthur Museum Garden & Library
- 10 Longwood Gardens
- 11 Rose Tree Park



# Brandywine Valley Attractions

Delaware County's Brandywine Country comes alive in the spring. You can stroll through the gardens and arboretums or learn about American history at many sites throughout the region. Even antiquing is more pleasant when you can top off your afternoon outdoors at a local winery or café.

Local museums preserve artifacts from our nation's past, while other attractions, such as the Franklin Mint and QVC Studio Park, showcase the technological prowess.

## LONGWOOD GARDENS

There's no better place to watch the wonders of spring unfold! Treat yourself to the breathtaking gardens and displays—with over 6,000 different types of plants making their appearance.

## BRANDYWINE BATTLEFIELD PARK

Take a trip back into American history as you tour Washington's Headquarters, Lafayette's quarters and the campsite of Washington's colonial troops.

## WINTERTHUR MUSEUM & GARDEN

Originally a private home in the duPont family, this 60-acre garden is a horticultural masterpiece. Along with the garden, Winterthur offers the impressive atmosphere of a world-class museum within the charming setting of a country estate. More than 89,000 objects represent a variety of American Art.

## BRANDYWINE RIVER MUSEUM

A 19th century grist mill is the setting to view major works of art by three generations of the Wyeth family and other American artists.

## FORT MIFFLIN ON THE DELAWARE

The site of a seven-week siege by the British Navy in 1777 and Confederate and Union Prison Camps during the Civil War.

## HAGLEY MUSEUM

An original duPont mansion, tour black powder mills, exhibits and a 1803 Georgian-style residence set amidst 230-acres of gardens.



LONGWOOD GARDENS



BRANDYWINE BATTLEFIELD



# Area Sporting Events

There's always great sports events happening in the Philadelphia area.

- The Philadelphia Flyers lace 'em up in the Wachovia Center while their American Hockey League affiliate, the Phantoms, take on the competition at the Wachovia Spectrum.
- Interested in NBA action? The Philadelphia 76ers, led by Allen Iverson, strut their stuff at the Center.
- If baseball's for you, root, root, root for the home team as the Philadelphia Phillies play at the beautiful Citizens Bank Park.
- If football's your game, the Philadelphia Eagles, depending on if they're NFC Champions, try to work their way back to the Super Bowl at the beautiful Lincoln Financial Field. Or, you can take in an Philadelphia Soul Arena League game. You might even catch a glimpse of team owner Jon Bon Jovi.
- Want more? There's always a full state of college sports events on tap in the area.





# Accommodations

- There's a wide variety of quality hotel choices within a short distance from IceWorks. We work with a number of fine hotels that offer tournament packages
- The rink's convenient location near Philadelphia International Airport and all major regional highways adds to the convenience of accommodations.



# Traveling to Philadelphia

## PHILADELPHIA INTERNATIONAL AIRPORT

Philadelphia International Airport (PHL) serves as the principal gateway for the fifth largest metropolitan population in the United States. Located approximately seven (7) miles from downtown Philadelphia, the Airport is easily accessible from Interstates 76, 95 & 476.

In June 2001, the Airport ushered in a new era of regional airline

service with the opening of Terminal F. This 185,000 square-foot facility offers 38 gates for regional and commuter jets, and was designed to accommodate 6 million passengers a year.

In May 2003, PHL celebrated the opening of its expansive new international terminal. Additional improvements associated with this construction include two new parking garages, and new northbound and southbound Interstate 95 exit ramps

In May of 2004, Philadelphia International Airport embarked on a new and exciting chapter in its long history when the nation's No. 1 low-fare carrier, Southwest Airlines, inaugurated service.

Philadelphia International Airport now serves nearly 25 million passengers annually.



## DIRECTIONS TO ICEWORKS

### FROM THE PHILADELPHIA AIRPORT AND POINTS NORTH:

Take I-95 south to Route 322 west. Go one mile and take the Route 452 exit. At the second light, turn right at Duttons Mill Road. The rink is on the left just past the Sun Credit Union. Travel time: approximately 20 minutes.

### FROM THE WILMINGTON, DELAWARE AREA AND POINTS SOUTH:

Take I-95 north to Exit 2 (Route 452). Turn left off the ramp going north on Rt. 452. Go 1.5 miles and turn right at Duttons Mill Road. The rink will be on the left just past the Sun Credit Union.

### FROM THE PENNSYLVANIA TURNPIKE WEST:

Take Exit 24 Valley Forge off the Turnpike. Continue through the toll booths and stay on Pa. 76 (Schuylkill Expressway) until Pa. 476 south. Take Pa. 476 south to the end where you take I-95 south. Follow directions from the Airport (above) to rink.

### FROM THE PENNSYLVANIA TURNPIKE EAST:

Take the Mid-County exit 25A off the Turnpike. Continue on Pa. 476 south to I-95 south. Follow directions from the Airport (above) to rink.



# Restaurants

Our area offers a vast selection of national chains convenient to our two skating complexes. Couple these choices with restaurants on the Main Line, in our suburbs or in Philadelphia and you can turn the trip into a world class dining experience.



---

# Special Tournament Features

**Spectator seating on all 4 rinks with heated restaurant seating available**

**Two restaurants in the facilities serving breakfast, lunch, dinner and snacks**

**Four ice surfaces (three NHL- and one Olympic-sized)**

**Large and clean player locker rooms with bathrooms and showers**

**On-site trained security personnel**

**On-site general manager**

**Ample parking**

- 500 car parking at the facility

**No driving tolls within a 20 mile radius**

**Additional products and services available:**

- Hospitals
- Pharmacies
- Laundromats
- Churches
- Shopping Malls. The Granite Run and Springfield Malls are a short drive away. The world famous King of Prussia Mall is around a 30 minute drive.
- Movie Theaters



*A Taste of*

# PHILADELPHIA

## SPECIAL PHILADELPHIA FOOD TREATS SERVED AT THE RINKS

- Soft Pretzels
- Hoagies
- Cheese Steaks
- Tastykakes



---

**Visit the Philadelphia area  
and have a great time at  
our tournament!**

**Contact  
Tournament Coordinator**

**MARY ANN DANISH**

**IceWorks Skating Complex  
701 West Duttons Mill Road**

**Aston, PA 19014**

**610-497-2200, Ext. 24**

**Fax: 610-485-7540**

**mdanish@iceworks.net**

